

Know Your Machine

- 1 – Pattern selection buttons
- 2 – Stitch adjustment buttons
- 3 – Spool holder/spool cap
- 4 – Spool pin
- 5 – Bobbin winding thread guide
- 6 – Thread guide
- 7 – Thread take-up lever
- 8 – Tension regulating dial
- 9 – Thread cutter
- 10 – Needle threader
- 11 – Needle plate/Throat plate
- 12 – Bobbin cover (plate)
- 13 – Bobbin cover (plate) release button
- 14 – Reverse button/Backstitch
- 15 – Speed control slider
- 16 – Needle clamp screw
- 17 – Needle
- 18 – Presser foot
- 19 – Foot holder/Ankle
- 20 – Bobbin winder (spindle)
- 21 – Hand wheel
- 22 – Power switch
- 23 – Buttonhole lever
- 24 – Presser foot lifter
- 25 – Feed (Draw in yourself.)

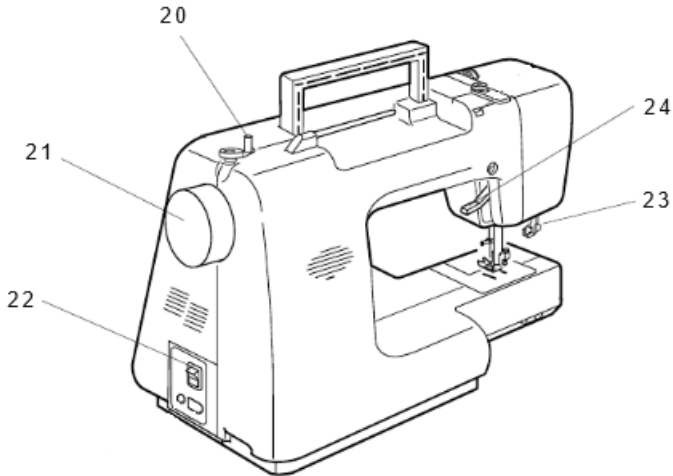
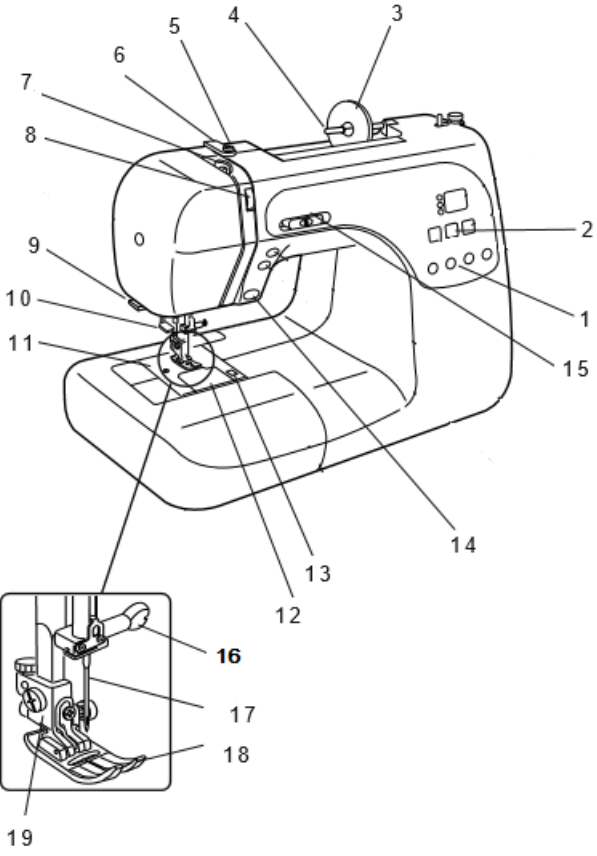

Machine Part Functions

1-Pattern Selection Button

2-Stitch Adjustments-change stitch length and width (creates zig-zags)

3/4-Spool Pin/Cap-hold the top thread in place

5-Bobbin Winding Thread Guide-is actually a tension disc that regulates tension for bobbin winding

6-Thread Guide-Leads thread to needle

7-Take-Up Lever-Controls flow of needle thread-must be threaded properly or machine will not work correctly

8-Tension Dial-Set tension according to fabric, stitch, and thread—how tight the thread is being pulled

9-Thread Cutter

10-Needle Threader

11-Needle Plate/Throat Plate-has measurements to help you sew straight, supports fabric during sewing

12-Bobbin Cover

13-Bobbin Cover Release Button

14-Reverse Stitch-can stitch backwards to lock stitches into place

15-Speed Control

16-Needle Clamp Screw-holds needle in place

17-Needle

18-Presser Foot-holds fabric against feed system/teeth

19-Foot Holder/Ankle-attaches presser foot to machine-button to release foot and can change easily to attach different feet

20-Bobbin Winder- guides thread when winding bobbins

21-Hand Wheel-controls movement of take up lever and needle, turn wheel towards you to stitch slowly

22-Power Switch

23-Buttonhold Lever-guide when making buttonholes

24-Presser Foot Lifter-raises and lowers presser foot

25-Feed-moves fabric along under presser foot